

SCHEDULE 1 – DESCRIPTION AND MAPS OF THE DETERMINATION AREA

Schedule 1, Determination Area

Comprises the following areas:

Part 1: West Area [Adnyamathanha / Ngadjuri]

Part 2: Central Area [Adnyamathanha / Ngadjuri / Wilyakali]

Part 3: East Area [Adnyamathanha / Wilyakali]

External Boundary Description

Commencing at Longitude 138.602767 East, Latitude 32.736300 South (west of the Town of Orroroo), then generally northerly passing in straight lines through the following coordinate points:-

Longitude East	Latitude South
138.606084	32.722854
138.617221	32.692713
138.618012	32.676753
138.615067	32.661502
138.607519	32.632771
138.605832	32.622485
138.600809	32.614163
138.597909	32.609359
138.590416	32.602262
138.585818	32.590201
138.587458	32.581690
138.585760	32.566794
138.582393	32.549414
138.575646	32.508270
138.563515	32.472799
138.557664	32.458255
138.548834	32.414627
138.549620	32.396540
138.557852	32.367108
138.566088	32.339449

138.575596	32.321721
138.608716	32.280596
138.623991	32.244429
138.621437	32.219600
138.617665	32.205767
138.613052	32.187677
138.609718	32.183065
138.587661	32.164257
138.547271	32.121679
138.527273	32.095779
138.525168	32.084429
138.516462	32.070776

[being along a portion of the eastern portion of the Nukunu Native Title Claim external boundary].

Then easterly in a straight line to the south-west corner of Allotment 50 in Filed Plan 251955, Three Creeks Pastoral Lease (PE2324); generally easterly along the southern boundary of Allotment 50; generally south-easterly and generally northerly along the southern and eastern boundaries of Allotment 700 in Filed Plan 251677, Holowilena South Pastoral Lease (PE2260A) to the south-east corner of Allotment 500 in Filed Plan 251778, Holowilena Pastoral Lease (PE2260) [being along a southern and eastern portion of Adnyamathanha No 1 – Stage 2 Native Title Determination Area external boundary].

Then generally northerly along the eastern boundary of Allotment 500; generally north-easterly along the south-eastern boundary of Block 849, OH(Parachilna), Bibliando Pastoral Lease (PE2262) to the south-west corner of Block 1218, OH(Parachilna), Glen Warwick Pastoral Lease (PE2307A) [being along a south-eastern portion of Adnyamathanha People No. 1 (Stage 1) Native Title Determination Area external boundary].

Then generally north-easterly along the southern boundary of Block 1218; southerly along a portion of the eastern boundary of Allotment 403 in Deposited Plan 42207, Curnamona Pastoral Lease (PE2326); generally easterly along the southern boundary of Allotment 403; south-easterly along a portion of the southern boundary of Block 910, OH(Curnamona), Glenorchy Pastoral Lease (PE2205) to its intersection with Longitude 139.719547 East [being a point on the northern portion of Ngadjuri Nation Native Title Claim external boundary and the western portion of Native Title Claim Wilyakali #2 external boundary]; generally north-easterly passing in straight lines through the following coordinate points:-

Longitude East	Latitude South
139.833014	31.824022
140.139892	31.495675

and north-easterly to an eastern corner of Adnyamathanha No 1 – Stage 2 Native Title Determination Area at Longitude 140.574604 East, Latitude 31.337067 South [being along a southern and south-eastern portion of Adnyamathanha No 1 – Stage 2 Native Title Determination Area external boundary].

Then south-easterly in a straight line toward the point defined as Longitude 140.633846 East, Latitude 31.514914 South until it intersects Latitude 31.476883 South [being along a portion of the western portion of Native Title Claim Malyankapa Peoples external boundary].

Then generally south-easterly and generally south-westerly in straight lines passing through the following coordinate points:-

Longitude East	Latitude South
140.633846	31.514914
140.662150	31.593447
140.704037	31.721444
140.752229	31.859829
140.781565	32.000311
140.783661	32.056922
140.766900	32.090470

and south-westerly in a straight line to the intersection of the southern boundary of the Barrier Highway road corridor with Longitude 140.761034 East (near the intersection of the Barrier Highway with Wompinie Road, east of the Town of Mingary); generally south-westerly along the southern boundary of the Barrier Highway road corridor to its intersection with the production southerly of the eastern boundary of Block 651, OH(Olary), Abminga Pastoral Lease (PE2273) (east of the Town of Olary) [being a point on the southern portion of Ngadjuri Nation Native Title Claim external boundary and the southern portion of Native Title Claim Wilyakali #2 external boundary]; south-westerly along the southern boundary of the Barrier Highway road corridor to its intersection with Longitude 140.361215 East (east of the Town of Olary) [being along a portion of the western portion of Native Title Claim Wilyakali external boundary].

Then generally south-westerly along the southern boundary of the Barrier Highway road corridor to its intersection with the centreline of Yunta Creek at approximately Longitude 139.572680° East (east of the Town of Yunta) [being along a portion of the western portion

of Native Title Claim Wilyakali external boundary and a portion of the northern portion of Native Title Claim Ngadjuri Nation #2 external boundary].

Then south-westerly along the southern boundary of the Barrier Highway road corridor to its intersection with Longitude 139.568233 East (east of the Town of Yunta) [being a point on the southern portion of Ngadjuri Nation Native Title Claim external boundary and the southern portion of Native Title Claim Wilyakali #2 external boundary]; generally south-westerly and generally westerly passing in straight lines through the following coordinate points:-

Longitude East	Latitude South
139.476249	32.618871
139.377774	32.658711
139.245777	32.692260
139.115874	32.717423
138.992257	32.732101
138.868639	32.736296
138.734545	32.736297
138.636070	32.738395
138.618260	32.736300

and in straight line to the point of commencement [being along a portion of the northern portion of Native Title Claim Ngadjuri Nation #2 external boundary].

Part 1: West Area [Adnyamathanha people / Ngadjuri people]
External Boundary Description

Commencing at Longitude 138.602767 East, Latitude 32.736300 South (west of the Town of Orroroo), then generally northerly passing in straight lines through the following coordinate points:-

Longitude East	Latitude South
138.606084	32.722854
138.617221	32.692713
138.618012	32.676753
138.615067	32.661502
138.607519	32.632771
138.605832	32.622485
138.600809	32.614163
138.597909	32.609359

138.590416	32.602262
138.585818	32.590201
138.587458	32.581690
138.585760	32.566794
138.582393	32.549414
138.575646	32.508270
138.563515	32.472799
138.557664	32.458255
138.548834	32.414627
138.549620	32.396540
138.557852	32.367108
138.566088	32.339449
138.575596	32.321721
138.608716	32.280596
138.623991	32.244429
138.621437	32.219600
138.617665	32.205767
138.613052	32.187677
138.609718	32.183065
138.587661	32.164257
138.547271	32.121679
138.527273	32.095779
138.525168	32.084429
138.516462	32.070776

[being along a portion of the eastern portion of the Nukunu Native Title Claim external boundary].

Then easterly in a straight line to the south-west corner of Allotment 50 in Filed Plan 251955, Three Creeks Pastoral Lease (PE2324); generally easterly along the southern boundary of Allotment 50; generally south-easterly and generally northerly along the southern and eastern boundaries of Allotment 700 in Filed Plan 251677, Holowilena South Pastoral Lease (PE2260A) to the south-east corner of Allotment 500 in Filed Plan 251778, Holowilena Pastoral Lease (PE2260) [being along a southern and eastern portion of Adnyamathanha No 1 – Stage 2 Native Title Determination Area external boundary].

Then generally northerly along the eastern boundary of Allotment 500; generally north-easterly along the south-eastern boundary of Block 849, OH(Parachilna), Bibliando Pastoral Lease (PE2262) to the south-west corner of Block 1218, OH(Parachilna), Glen Warwick Pastoral Lease (PE2307A) [being along a south-eastern portion of Adnyamathanha People No. 1 (Stage 1) Native Title Determination Area external boundary].

Then generally north-easterly along the southern boundary of Block 1218; southerly along a portion of the eastern boundary of Allotment 403 in Deposited Plan 42207, Curnamona Pastoral Lease (PE2326); generally easterly along the southern boundary of Allotment 403; south-easterly along a portion of the southern boundary of Block 910, OH(Curnamona), Glenorchy Pastoral Lease (PE2205) to its intersection with Longitude 139.719547 East [being along a southern portion of Adnyamathanha No 1 – Stage 2 Native Title Determination Area external boundary].

Then south-westerly in a straight line to the south-west corner of Block 929, OH(Olary), Tin Hut Pastoral Lease (PE2376); south-westerly in a straight line to an eastern corner of Section 1012, OH(Orroroo) at Latitude 32.270269 South; south-westerly in a straight line to the north-east corner of Section 302, Hundred of Waroonee; southerly in a straight line to the intersection of the southern boundary of Section 278, Hundred of Waroonee with Longitude 139.346575 East; southerly in a straight line to the south corner of Section 267, Hundred of Waroonee; generally south-easterly passing in straight lines through the following coordinate points:-

Longitude East	Latitude South
139.376731	32.536398
139.420760	32.570485
139.491775	32.586108

and easterly in straight line to the intersection of the southern boundary of the Barrier Highway road corridor with Longitude 139.568233 East (east of the Town of Yunta) [being along a portion of the western portion of Native Title Claim Wilyakali #2 external boundary].

Then generally south-westerly and generally westerly passing in straight lines through the following coordinate points:-

Longitude East	Latitude South
139.476249	32.618871
139.377774	32.658711
139.245777	32.692260
139.115874	32.717423
138.992257	32.732101

138.868639	32.736296
138.734545	32.736297
138.636070	32.738395
138.618260	32.736300

and in straight line to the point of commencement [being along a portion of the northern portion of Native Title Claim Ngadjuri Nation #2 external boundary].

Part 2: Central Area [Adnyamathanha / Ngadjuri / Wilyakali]

External Boundary Description

Commencing at the intersection of the southern boundary of the Barrier Highway road corridor with Longitude 139.568233 East (east of the Town of Yunta); generally north-westerly passing in straight lines through the following coordinate points :-

Longitude East	Latitude South
139.491775	32.586108
139.420760	32.570485
139.376731	32.536398

north-easterly in a straight line to the south corner of Section 267, Hundred of Waroonee; northerly in a straight line to the intersection of the southern boundary of Section 278, Hundred of Waroonee with Longitude 139.346575 East; northerly in a straight line to the north-east corner of Section 302, Hundred of Waroonee; north-easterly in a straight line to an eastern corner of Section 1012, OH(Orroroo) at Latitude 32.270269 South; north-easterly in a straight line to the south-west corner of Block 929, OH(Olary), Tin Hut Pastoral Lease (PE2376); north-easterly in a straight line to the intersection of the southern boundary of Block 910, OH(Curnamona), Glenorchy Pastoral Lease (PE2205) with Longitude 139.719547 East [being along a portion of the western portion of Native Title Claim Wilyakali #2 external boundary].

Then south-easterly along the southern boundary of Block 910; generally north-easterly along a portion of the western boundary of Allotment 113 in Filed Plan 250354, Plumbago Pastoral Lease (PE2250); generally south-easterly along the northern boundary of Allotment 113; generally south-easterly and generally south-westerly along the northern and eastern boundaries of Allotment 1 in Filed Plan 219181, Bimbowrie Conservation Park; generally southerly along the eastern boundary of Block 651, OH(Olary), Abminga Pastoral Lease (PE2273) to the south-east corner of Block 651; southerly along the production southerly of the eastern boundary of Block 651 to its intersection with the southern boundary of the Barrier Highway road corridor (east of the Town of Olary) [being along a portion of the northern portion and the eastern portion of Ngadjuri Nation Native Title Claim external boundary].

Then south-westerly along the southern boundary of the Barrier Highway road corridor to its intersection with Longitude 140.361215 East (east of the Town of Olary) [being along a portion of the western portion of Native Title Claim Wilyakali external boundary].

Then generally south-westerly along the southern boundary of the Barrier Highway road corridor to its intersection with the centreline of Yunta Creek at approximately Longitude 139.572680° East (east of the Town of Yunta) [being along a portion of the western portion of Native Title Claim Wilyakali external boundary and a portion of the northern portion of Native Title Claim Ngadjuri Nation #2 external boundary].

Then south-westerly along the southern boundary of the Barrier Highway road corridor to the point of commencement [being along a portion of the northern portion of Native Title Claim Ngadjuri Nation #2 external boundary].

Part 3: East Area [Adnyamathanha / Wilyakali]
External Boundary Description

Commencing at the intersection of the southern boundary of the Barrier Highway road corridor with the production southerly of the eastern boundary of Block 651, OH(Olary), Abminga Pastoral Lease (PE2273) (east of the Town of Olary).

Then northerly across the Barrier Highway along the said production to the south-east corner of Block 651; generally northerly along the eastern boundary of Block 651; generally north-easterly and generally north-westerly along the eastern and northern boundaries of Allotment 1 in Filed Plan 219181, Bimbowrie Conservation Park; generally north-westerly along the northern boundary of Allotment 113 in Filed Plan 250354, Plumbago Pastoral Lease (PE2250); generally south-westerly along a portion of the western boundary of Allotment 113 to the south corner of Block 910, OH(Curnamona), Glenorchy Pastoral Lease (PE2205); north-westerly along a portion of the southern boundary of Block 910 to its intersection with Longitude 139.719547 East [being along the eastern portion and a portion of the northern portion of Native Title Claim Ngadjuri Nation external boundary].

Then generally north-easterly passing in straight lines through the following coordinate points:-

Longitude East	Latitude South
139.833014	31.824022
140.139892	31.495675

and north-easterly to an eastern corner of Adnyamathanha No 1 – Stage 2 Native Title Determination Area at Longitude 140.574604 East, Latitude 31.337067 South [being along a

southern and south-eastern portion of Adnyamathanha No 1 – Stage 2 Native Title Determination Area external boundary].

Then south-easterly in a straight line toward the point defined as Longitude 140.633846 East, Latitude 31.514914 South until it intersects Latitude 31.476883 South [being along a portion of the western portion of Native Title Claim Malyankapa Peoples external boundary].

Then generally south-easterly and generally south-westerly in straight lines passing through the following coordinate points:-

Longitude East	Latitude South
140.633846	31.514914
140.662150	31.593447
140.704037	31.721444
140.752229	31.859829
140.781565	32.000311
140.783661	32.056922
140.766900	32.090470

and south-westerly in a straight line to the intersection of the southern boundary of the Barrier Highway road corridor with Longitude 140.761034 East (near the intersection of the Barrier Highway with Wompinie Road, east of the Town of Mingary); generally south-westerly along the southern boundary of the Barrier Highway road corridor to the point of commencement [being along a portion of the western portion of Native Title Claim Wilyakali external boundary].

Reference datum

Geographical coordinates have been provided by the NNTT Geospatial services and geographical coordinates are referenced to the Geocentric Datum of Australia 1994 (GDA94), in decimal degrees.

Watercourses and water-bodies referenced to 1:250,000 Topographic Mapping Series 3 – sourced from Geoscience Australia.

Use of Coordinates

Where coordinates are used within the description to represent cadastral or topographical boundaries or the intersection with such, they are intended as a guide only. As an outcome of the custodians of cadastral and topographical data continuously recalculating the geographic position of their data based on improved survey and data maintenance procedures, it is not possible to accurately define such a position other than by detailed ground survey.

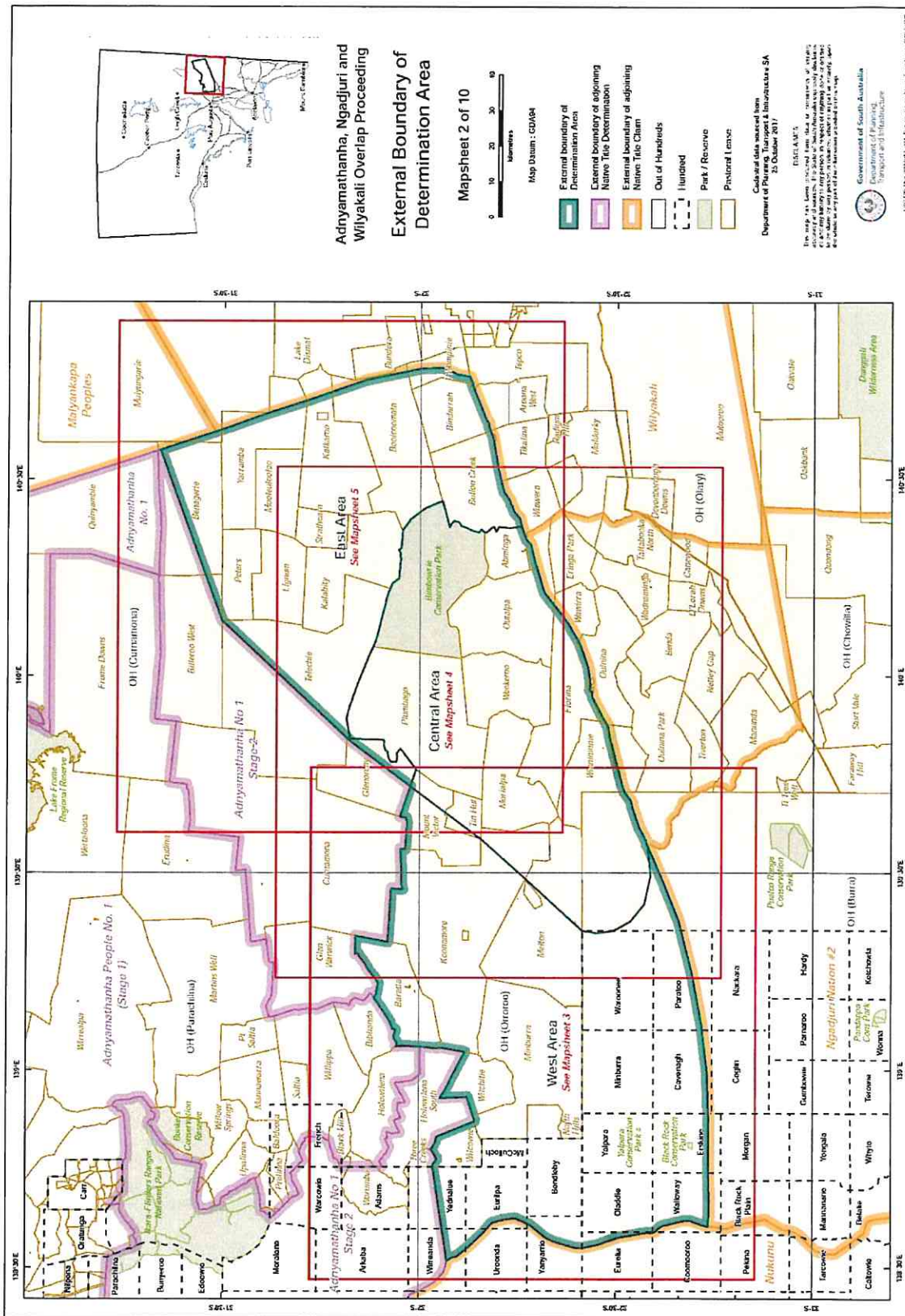

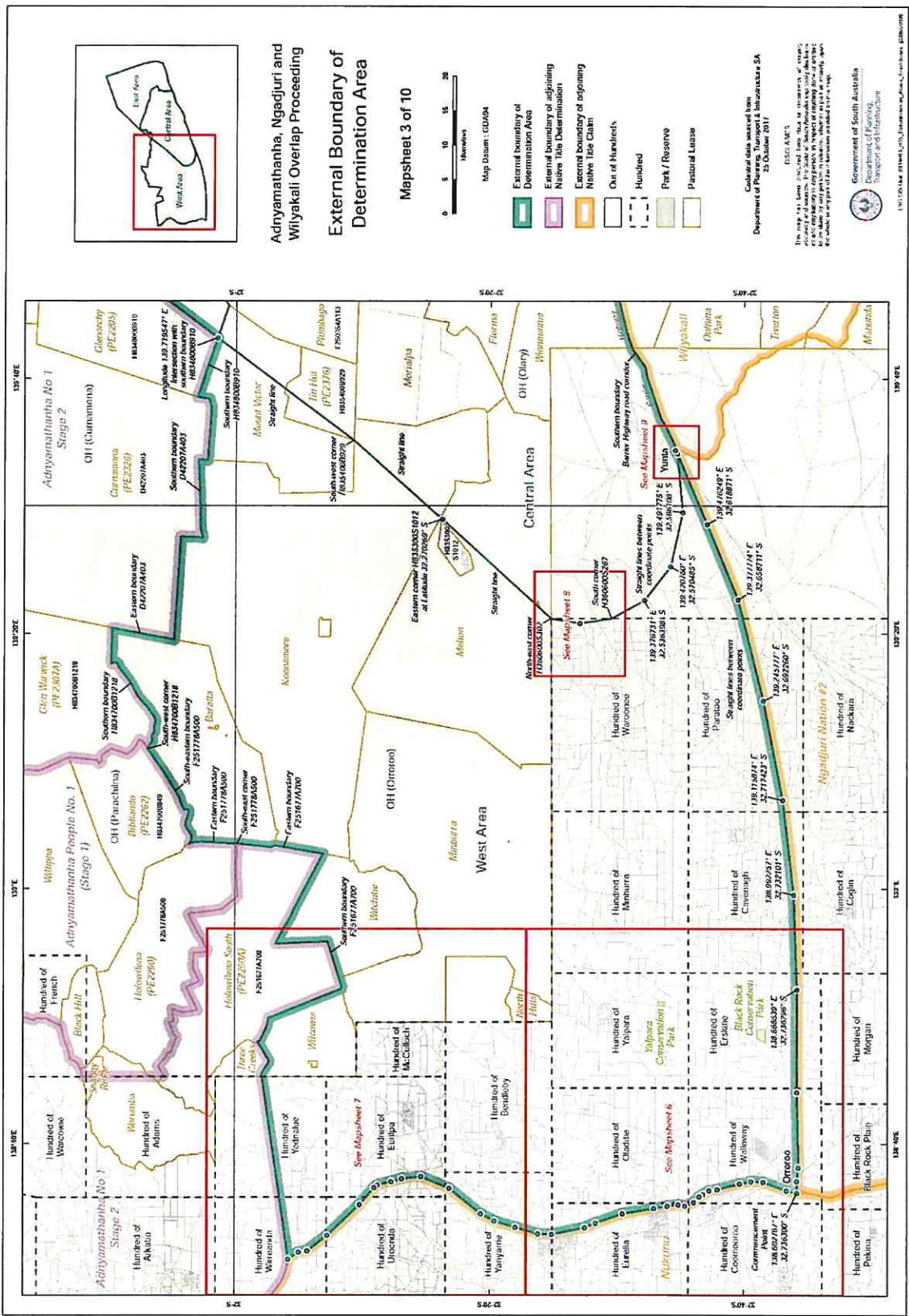

Government of South Australia
 Department of Planning,
 Transport and Infrastructure

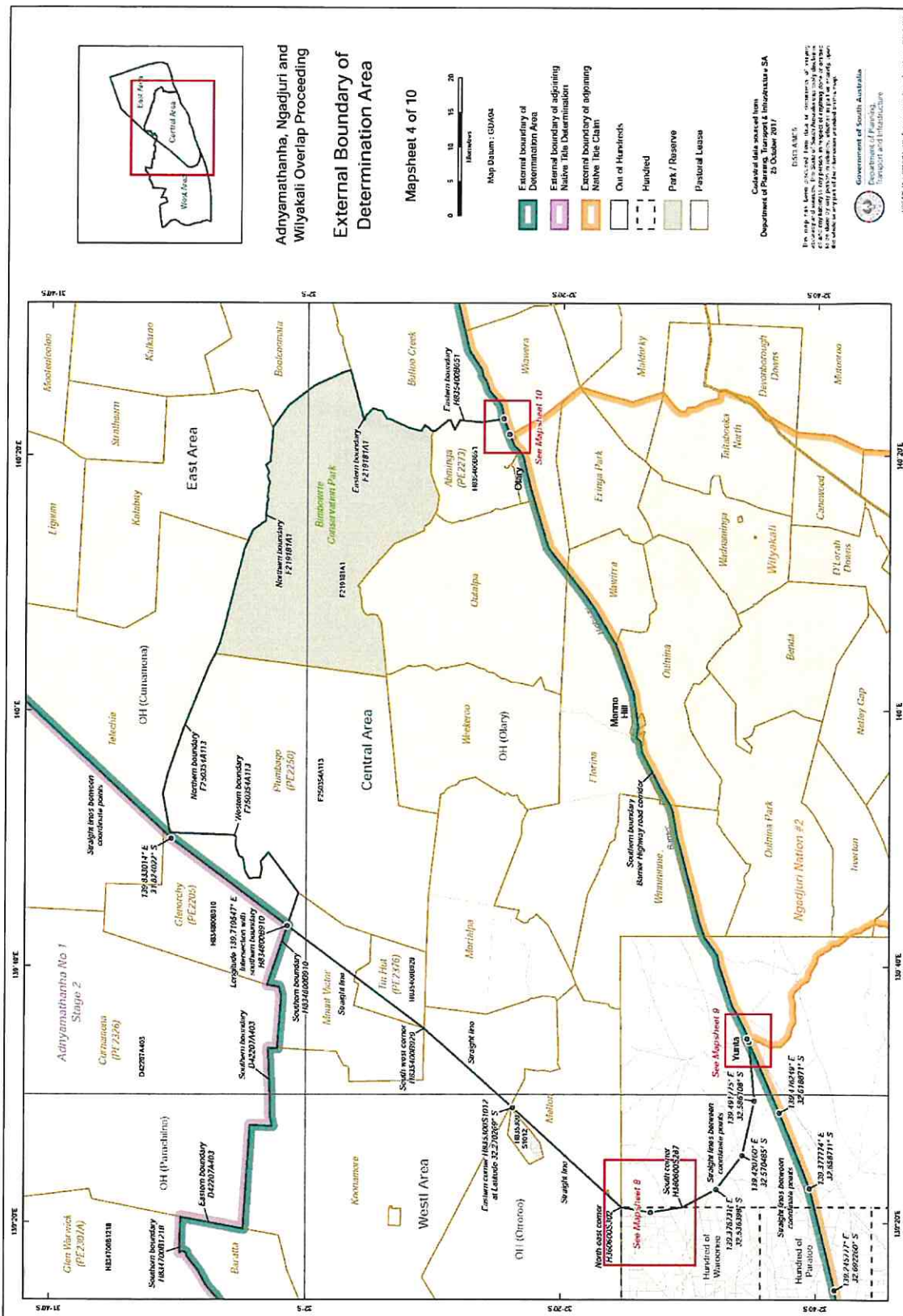

- xxviii -

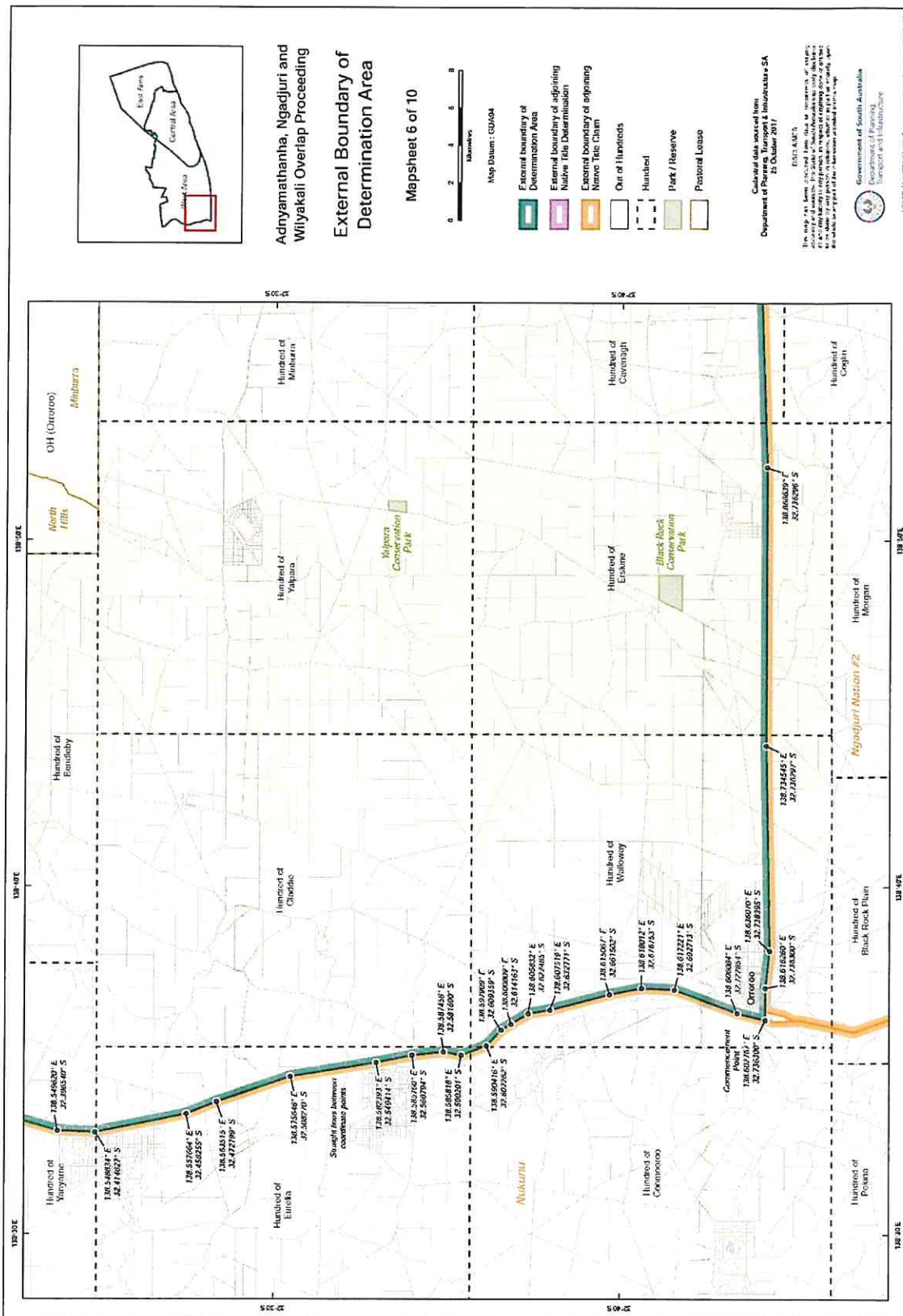

- XXX -

